

Emergency Plan

Fire Escape/Evacuation Plan

Fire Escape Plan - Browsea Water Activities Centre

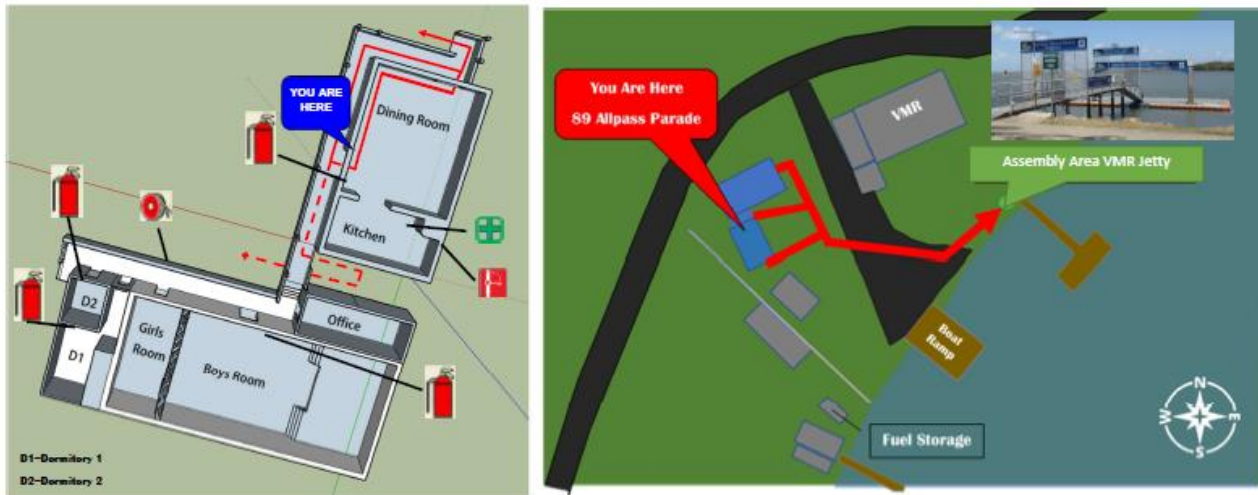

<ul style="list-style-type: none"> - Path of Exit - Alternate Path - Fire Extinguisher - First Aid kit - Hose Reel - Gas Isolation point 	<p>IN CASE OF FIRE</p> <ul style="list-style-type: none"> • Remove People from immediate danger, if you detect anything unusual (Should you hear the smoke detectors, SMOKE, FLAMES or THE SMELL OF BURNING). Report it to your leader immediately. • Alert the Fire Brigade (000 or 112) • Confine the Fire, by closing all windows and doors (IF SAFE TO DO SO AND TIME IS PERMITTING) • Evacuate the centre and assemble at the assembly point beside the VMR jetty. • Follow the instructions from leaders and fire-fighters. <p>Above all, stay calm and don't panic.</p>	
--	---	--

Drawn by Liam Noonan 31st of March 2017 Version 0.3

Fire Warden

In the evening the Water Activities Team may have gone home. The Leaders who make the booking are required to have briefed everyone that is staying how to evacuate, to make sure the building is clear and to ensure the Emergency Services are notified. You are the designated Wardens for the duration of your stay.

Fire Extinguishers

All of the fire extinguishers at Browsea are powder extinguishers. Powder extinguishers are a good multi-purpose fire extinguisher because they can be used on Class A, B and C fires. They can also be used on fires involving electrical equipment however, they do not cool the fire so be aware that it can re-ignite.

Fire Blanket

A fire blanket is in the kitchen for use on pan fires. Remember to wrap it around your fingers to prevent burns to your hands.

Smoke Alarms

We have an interconnected Smoke detection alarm system.

Hose Reel

There is a red fire hose both upstairs and downstairs in the red hose reel. In an emergency, if safe to do so use on the fire. Water must not be used on an electrical or fat fire. It is there to get people out in an emergency, don't put yourself in danger saving our buildings.

Emergency Plan

Evacuation Point

Our assembly area for an evacuation is in-front of the VMR Jetty. This keeps people away from the driveway which the Fire Brigade will use to access water and the building.

